

GENERAL NOTES:

ALL DRAWINGS TO BE READ IN CONJUNCTION WITH RELEVANT STRUCTURAL ENGINEERS DRAWINGS, WINDOW & DOOR SCHEDULES, M&E DRAWINGS & DATA SHEETS.

RED DASHED LINE AROUND WC DENOTES PART M CLEAR ACCESS REQUIREMENT, NO OBSTRUCTIONS WITHIN THIS ZONE. BASIN MAY PROJECT INTO ZONE BUT SHOULD NOT IMPEDE ACCESS

PRINCIPAL ENTRANCE TO HAVE LEVEL THRESHOLD & CLEAR OPENING OF MIN. 775MM.
ALL INTERNAL DOORS TO PROVIDE CLEAR OPENING OF MIN. 775MM. & INTERNAL CORRIDOR WIDTH OF MIN. 750MM.

REFER TO M&E DRAWINGS FOR SWITCH & SOCKET SETTING OUT HEIGHTS.

PARTY WALLS TO BE CONSTRUCTED AS DETAIL DRAWING 07 & 08 1705-552 & 1705-553 USING ISOWALL WITH INTEGRAL SOUNDBLOC & ADDITIONAL EARTHWOOL INSULATION.

NON PARTY WALLS TO BE STANDARD ISOWALL PANEL BUILD UP AND OMIT EARTHWOOL INSULATION TO VOID.

KITCHEN UNITS AS SUPPLIED BY ELFIN, SHELVES TO UNIT TO BE FIXED IN FACTORY.

WARDROBE TO BE VARIA 1 DOOR WARDROBE, WHITE, FROM WAYFAIR WITH HANGING RAIL, WARDROBE ASSEMBLED & FIXED IN PLACE IN FACTORY.

ALL CONTAINERS & ALL STEEL COVER PLATES, & STEEL MOUNTING PLATES TO BE PAINTED EXTERNALLY ANTHRACITE GREY, RAL 7016 USING CONTAINERGARD 1 TOUCH UP PAINT, OIL BASED, MATT FINISH. ENSURE PAINT HAS A CLASS 0 SURFACE SPREAD OF FLAME.

ALL UNITS TO INCLUDE WINDOW & DOOR BLINDS.

FR = FROSTED GLASS
TG = TOUGHENED GLASS

SEE DRAWING 1705-BR-162 FOR FIRE SEPARATION.

DOOR SCHEDULE									
MARK	DOOR TYPE REF	STR. WIDTH	STR. HEIGHT	FD RATING	TRICKLE VENT	TOUGHENED GLASS	HARDWARE	COMMENTS	
EX DD1	TYPE 01H	970	2100	30s	N/A	YES	BRUSHED STAINLESS STEEL	FROSTED GLASS, TOUGHENED WITHIN 800MM FROM FFL. FRAME & GLAZING (ENTIRE DOOR UNIT) TO BE 30MIN FIRE RATED WITH SMOKE SEAL & SELF CLOSING DEVICE. BOHEMIA TWIN, STANDARD BLACK, HURST DOORS	
DD1	TYPE 02	915	2035	N/A	N/A	N/A	BRUSHED STAINLESS STEEL	DOOR LEAF 838 X 1981. DOOR UNDERCUT TO AID BACKGROUND VENTILATION SYSTEM. PDS DOORS	
DD2	TYPE 02	915	2035	30	N/A	N/A	BRUSHED STAINLESS STEEL	DOOR LEAF 838 X 1981. TO INCLUDE INSTUMESCENT FIRE GRILLE FOR VENTILATION. REFER TO DOOR TYPE ELEVATIONS. PDS DOORS	
DD3	TYPE 02	915	2035	30	N/A	N/A	BRUSHED STAINLESS STEEL	DOOR LEAF 838 X 1981. TO INCLUDE INSTUMESCENT FIRE GRILLE FOR VENTILATION. REFER TO DOOR TYPE ELEVATIONS. PDS DOORS	
DD4	TYPE 02	915	2035	30	N/A	N/A	BRUSHED STAINLESS STEEL	DOOR LEAF 838 X 1981 TO INCLUDE INSTUMESCENT FIRE GRILLE FOR VENTILATION.REFER TO DOOR TYPE ELEVATIONS. PDS DOORS	

WINDOW SCHEDULE									
MARK	WINDOW TYPE REF	STR. WIDTH	STR. HEIGHT	CILL HEIGHT	FIRE RATING	TRICKLE VENT	TOUGHENED GLASS	HARDWARE	COMMENTS
WD1	TYPE 01	2090	2310	FLUSH TO FFL	REFER TO UNIT DATA SHEET. SEE COMMENTS	YES - 2ND. 2500MM² FITTED TO HEADS	NO	BRUSHED STAINLESS STEEL	INSULATED INFILL PANELS TO ACHIEVE MIN. 81 'DIFFICULT TO IGNITE' REACTION TO FIRE RATING, CLASS 0 SURFACE SPREAD OF FLAME TO EXTERNAL CLADDING WHERE REQUIRED. INTERNAL INSULATION PANEL APPROX. 70MM THICK TO WINDOW MANUFACTURERS DESIGN REFER TO UNIT DATA SHEETS FOR ANY REQUIREMENTS REGARDING WINDOW FIRE INTEGRITY.
WD2	TYPE 01H	2090	2310	FLUSH TO FFL	REFER TO UNIT DATA SHEET. SEE COMMENTS	YES - 2ND. 2500MM² FITTED TO HEADS	NO	BRUSHED STAINLESS STEEL	
WD3	TYPE 02	2090	2310	FLUSH TO FFL	REFER TO UNIT DATA SHEET. SEE COMMENTS	YES - 2ND. 2500MM² FITTED TO HEADS	YES	BRUSHED STAINLESS STEEL	

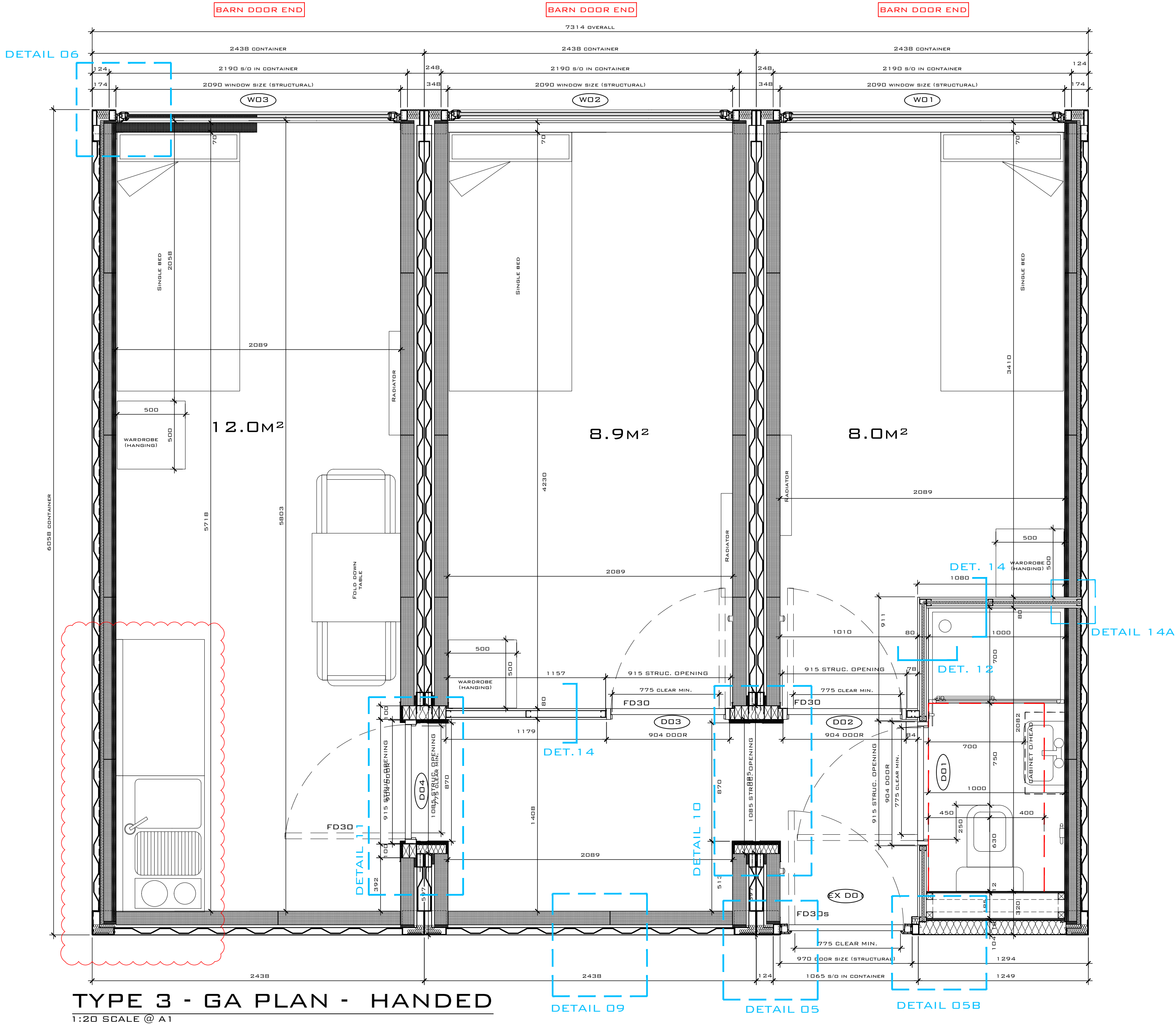

DRAWING SCALE 1:20 @ A1
DRAWING SCALE 1:40 @ A3

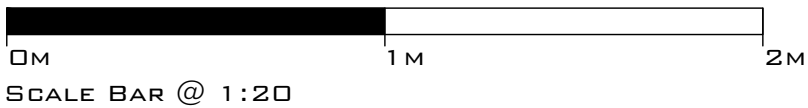

CDM 2015
Residual Risk

THR CONTRACTORS SHALL FAMILIARISE THEMSELVES WITH THE PROJECT AND EMPLOY SYSTEMS AND METHODS OF WORKING TO REDUCE ANY HAZARDS

THE CONTRACTORS SHALL PLAN, MANAGE, MONITOR AND COORDINATE HEALTH AND SAFETY DURING THE CONSTRUCTION PHASE OF A PROJECT

IF IN DOUBT ASK AND NOTIFY THE DESIGN TEAM

GENERAL

IT IS ASSUMED THAT A COMPETENT CONTRACTOR FAMILIAR WITH THE WORKS REQUIRED WILL BE APPOINTED AND THAT THEY WILL BE AWARE OF THE STANDARD HAZARDS.

NOTES:

- DRAWINGS SHOULD ONLY BE SCALED FOR PLANNING PURPOSES. DO NOT SCALE FROM THIS DRAWING FOR CONSTRUCTION PURPOSES.
- ALL DIMENSIONS ARE IN MM, UNLESS STATED OTHERWISE.
- ALL DIMENSIONS TO BE CHECKED ON SITE PRIOR TO CONSTRUCTION OR ORDERING.
- ANY ERRORS OR OMISSIONS TO BE NOTIFIED TO CITIZEN LLP IMMEDIATELY.
- CONTRACTOR TO READ & CHECK ALL MANUFACTURES LITERATURE AND IMPLEMENT ITS REQUIREMENTS PRIOR TO INSTALLATION OF ANY MATERIALS AND COMPONENTS.
- CITYZEN LIMITED IS NOT RESPONSIBLE FOR ANY BUILDING WORK THAT IS CARRIED OUT ON SITE.
- THIS DRAWING IS TO BE READ IN CONJUNCTION WITH ALL NECESSARY ARCHITECTURAL, STRUCTURAL AND SPECIALIST DRAWINGS, SPECIFICATIONS, SCOPES OF WORK & ROOM DATA SHEETS.
- ALL MATERIALS AND WORKMANSHIP SHALL CONFORM WITH THE RELEVANT BRITISH AND EUROPEAN STANDARD, SPECIFICATIONS AND CODES OF PRACTICE.
- IF IN ANY DOUBT, ASK.

- WALKWAY DESIGN BY OTHERS. FINAL WALKWAY JUNCTIONS TBC.

- CONTAINER DIMENSIONS CAN VARY. ALL DIMENSIONS SHOULD BE CHECKED BEFORE SITE INSTALLATION.

D	04.09.17	ELFIN UNIT HANDED INTERNAL INSULATED PANEL ADDED	AG	JS	JS
C	21.07.17	DOOR SIZE REVISED TO MATCH PDS DOORS	RS	JS	JS
B	17.07.17	FIRE PARTITION UPDATED, WARDROBE SPEC REVISED	RS	JS	JS
A	11/07/17	DETAIL REFERENCES ADDED, NOTES ADDED	MJ	JS	JS
REV	DATE	REVISION	DRAWN	CHECKED	APPROVED

COPYRIGHT CITYZEN LIMITED

CITYZEN

ARCHITECTURE | ENVIRONMENT

MARITIME HOUSE
BASIN ROAD NORTH
HOVE
EAST SUSSEX
BN41 1WR

CONTACT@CITYZENDESIGN.CO.UK
WWW.CITYZENDESIGN.CO.UK
01273 704 901

CLIENT:

CARGOTEK

DESIGNER:

ROMAN SCHNECKER

PROJECT:

CARGOTEK 20FT PRODUCT

TITLE:

TYPE 3 - GA PLAN - HANDED

SCALE:	1:20 @ A1	DATE:	27.06.17
PURPOSE OF DRAWING:			
CONSTRUCTION			
DRAWING: PROJECT REF - DRG NO. (REVISION)			
1705-CR-H252 (D)			